

PARTS LIST

ITEM	QTY	PART NUMBER	DESCRIPTION
1	1	2614-006-1	M/STEEL HOOK BODY - Z/C PASSIVATE
2	1	2614-006-2	M/STEEL HOOK CATCH - Z/C PASSIVATE
3	1	2614-006-3	M/STEEL CATCH RIVET - Z/C PASSIVATE
4	1	2614-006-4	M/STEEL CATCH SPRING CLIP - P/C BLACK
5	9	2614-006-5	M/STEEL CHAIN LINK - Z/C PASSIVATE

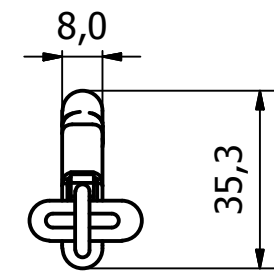
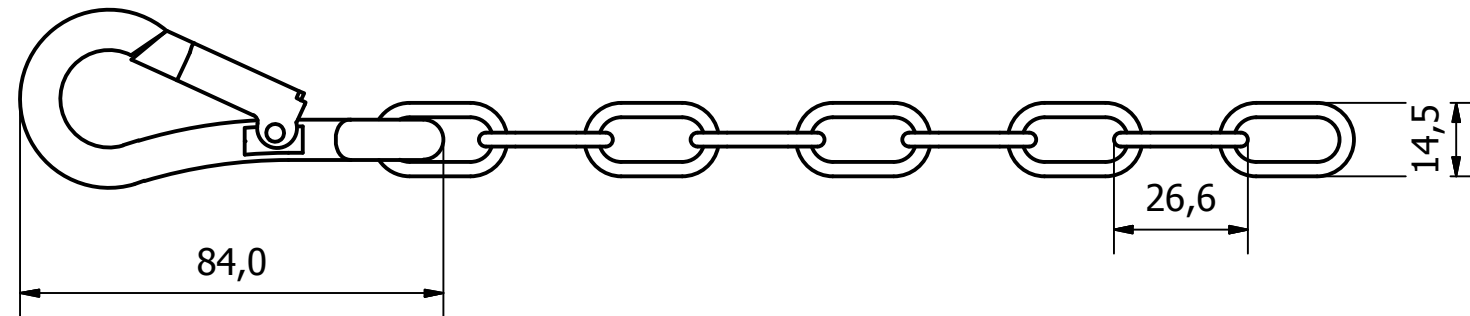
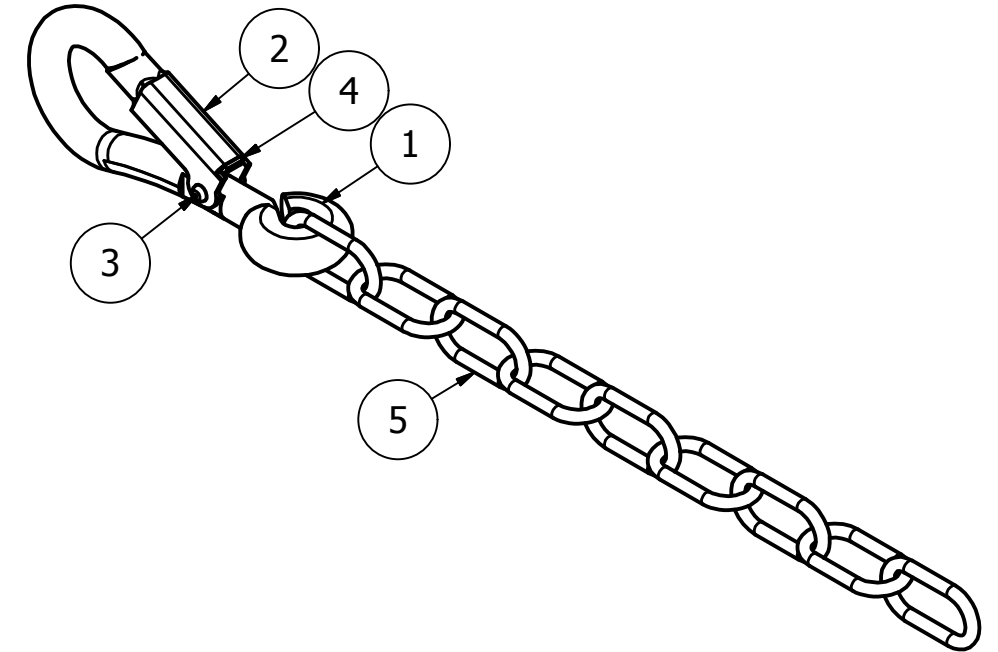
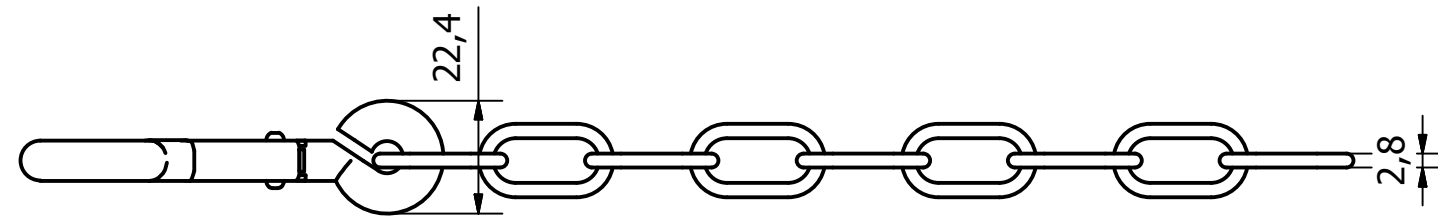

NOTE:  
CHAIN CONSISTS OF 9 LINKS - 195mm LONG

GENERAL TOLERANCES ON LENGTHS
0.5 - 6 ± 0.1mm
6 - 30 ± 0.2mm
30 - 120 ± 0.3mm
120 - 400 ± 0.5mm
400 - 1000 ± 0.8mm
1000 - 2000 ± 1.2mm
2000 - 4000 ± 2.0mm

ALBERT JAGGER LTD  
GREEN LANE  
WALSALL PHONE: 01922 471000  
WEST MIDLANDS FAX: 01922 648021  
WS2 8HG

THIS DRAWING & THE DESIGN SHOWN ARE THE PROPERTY OF ALBERT JAGGER LTD AND MUST NOT BE USED OR COPIED BY A THIRD PARTY WITHOUT PERMISSION

DRAWN BY  
U.F

CHECKED BY  
A.P



SCALE  
1:1.5

MATERIAL  
SEE TABLE

MASS  
0.090 kg

FINISH  
SEE TABLE

Date  
16/08/2017

ALL DIMS IN MM UNLESS STATED DO NOT SCALE

1  
REV

VALIDATION COMPLETE  
DESCRIPTION

31/08/17  
DATE

A.P  
APPROVED



M/STEEL SPRING HOOK C/W CHAIN  
2614-006

Edition 1  
Sheet 1 / 1